

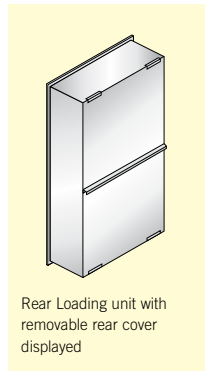

3614
14 Front Loading
B doors (13 usable)



Sample Rear
Loading Unit



Rear Loading unit with
removable rear cover
displayed

SAMPLE INSTALLATION

Model displayed:
(2) 3635's front
loading units

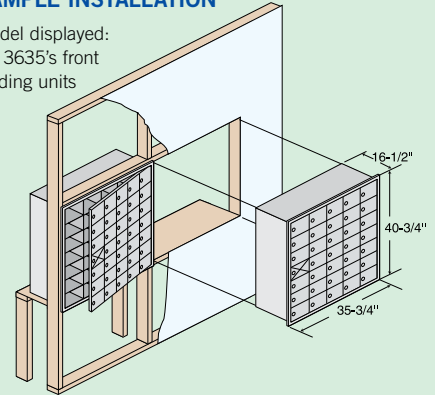

Note: For U.S.P.S. serviced installations, the tenant locks in the top row of mailboxes must be no more than 67" above the finished floor and the bottom of the lowest row must be no less than 28" above the finished floor.

4B+ STANDARD HORIZONTAL MAILBOXES - FRONT LOADING (FL) OR REAR LOADING (RL) - U.S.P.S. APPROVED

MODEL	DESCRIPTION	UNIT SIZE - FL and RL (includes trim)	WEIGHT	PRICE
7 DOOR HIGH UNITS - 40-3/4" H				
3621 ^{1,2,3}	21 A Doors (20 usable on FL)	22-3/4" W x 40-3/4" H x 16-1/2" D	70 lbs.	\$735.00
3628 ^{1,2,3}	28 A Doors (27 usable on FL)	29-1/4" W x 40-3/4" H x 16-1/2" D	85 lbs.	\$980.00
3635 ^{1,2,3}	35 A Doors (34 usable on FL)	35-3/4" W x 40-3/4" H x 16-1/2" D	100 lbs.	\$1,225.00
3614 ^{1,2,3}	14 B Doors (13 usable on FL)	29-1/4" W x 40-3/4" H x 16-1/2" D	85 lbs.	\$770.00
6 DOOR HIGH UNITS - 35-1/4" H				
3618 ^{1,2,3}	18 A Doors (17 usable on FL)	22-3/4" W x 35-1/4" H x 16-1/2" D	60 lbs.	\$630.00
3624 ^{1,2,3}	24 A Doors (23 usable on FL)	29-1/4" W x 35-1/4" H x 16-1/2" D	75 lbs.	\$840.00
3630 ^{1,2,3}	30 A Doors (29 usable on FL)	35-3/4" W x 35-1/4" H x 16-1/2" D	90 lbs.	\$1,050.00
3612 ^{1,2,3}	12 B Doors (11 usable on FL)	29-1/4" W x 35-1/4" H x 16-1/2" D	75 lbs.	\$660.00
5 DOOR HIGH UNITS - 29-3/4" H				
3615 ^{1,2,3}	15 A Doors (14 usable on FL)	22-3/4" W x 29-3/4" H x 16-1/2" D	55 lbs.	\$525.00
3620 ^{1,2,3}	20 A Doors (19 usable on FL)	29-1/4" W x 29-3/4" H x 16-1/2" D	65 lbs.	\$700.00
3625 ^{1,2,3}	25 A Doors (24 usable on FL)	35-3/4" W x 29-3/4" H x 16-1/2" D	75 lbs.	\$875.00
3610 ^{1,2,3}	10 B Doors (9 usable on FL)	29-1/4" W x 29-3/4" H x 16-1/2" D	65 lbs.	\$550.00
3675	Master commercial lock - for front loading mailbox unit - with (2) keys - if for private access			\$25.00
3686	Combination lock - 3 digit spring latch - additional per door - for installations not serviced by the U.S.P.S.			\$10.00
3690	Lock - standard replacement for 3600 series doors - with (2) keys			\$8.00
3699	Key blanks - for standard 3600 series locks - box of (50)			\$30.00

¹ Specify



aluminum



bronze



gold



sandstone

² Specify - front loading or rear loading

³ Specify - U.S.P.S. access or private access (order master commercial lock #3675 - on front loading units only)

4B+ STANDARD HORIZONTAL MAILBOX OPTIONS

- Master commercial lock - when front loading units are for private access with (2) keys (#3675 - \$25.00)
 - Card holder - clear plastic - card and metal insert included (#3697 - \$3.00)
 - Self-adhesive numbers - sheets of (100) (#3695 - \$15.00)
 - 4B+ Master door security retrofit kit (#3696 - \$50.00)
- Each mailbox door includes a five (5) pin cylinder cam lock with two (2) keys (1,000 different key changes).
- Additional keys per lock when ordering (#3698 - \$2.00)
 - Key blanks - box of (50) (#3699 - \$30.00)

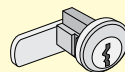

#3690
Lock for
3600 series
\$8.00



#3698
Additional keys
for #3690
\$2.00 per key

Note: On front loading horizontal mailboxes, one opening per unit is required for a master postal or commercial lock and cannot be used for mail distribution. On rear loading units, all openings are usable.

STANDARD FRONT LOADING CONFIGURATIONS

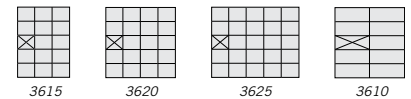
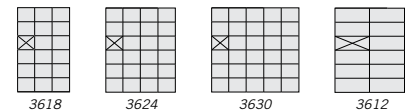
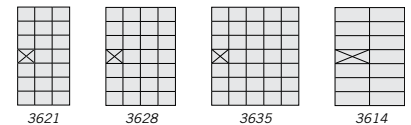

3600 SERIES DOOR SIZES

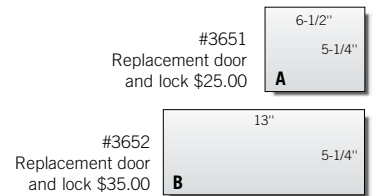

DOOR AND COMPARTMENT IDENTIFICATION

Each mailbox door includes a 2" W x 5/8" H clear plastic card holder to identify the tenant's name and/or box number. Self-adhesive numbers (1-3000 available) are supplied upon request with a standard order. Custom identification systems are available as an option upon request. Label holders (#1070 - \$30.00 - page 73) neatly organize and identify the front/rear of the mailbox compartments and are available as an option upon request.

CUSTOM ENGRAVED PLACARDS (#3667)

2" W x 5/8" H custom engraved self-adhesive placards are available as an option upon request. \$3.00

